

**RESPECT  
RESPONSIBILITY  
COMMITMENT**

# RUTHERFORD TECHNOLOGY HIGH SCHOOL NEWSLETTER



31 October, 2014

Email: [rutherford-h.school@det.nsw.edu.au](mailto:rutherford-h.school@det.nsw.edu.au)

[www.rutherfordhs.nsw.edu.au](http://www.rutherfordhs.nsw.edu.au)

Telephone: 4932 5999

Fax: 4932 8166

<http://www.facebook.com/RutherfordTechnologyHighSchool>

## **CALENDAR**

11th November-Yr 12 Formal

12th November - Yr 7 & 8  
Cricket/Netball Gala day

18th November-P&C Meeting

26th November-Year 9  
Excursion to Wet & Wild

2nd December-Yr 7 2015  
Parent Info Night

3rd December-Yr 7 2015  
Orientation Day

15th December-Presentation  
Day

## **Office Opening Hours**

Please be aware the office is open Monday to Friday between 8am and 4pm. Outside office hours a message may be left on the school answering machine.

Parents and caregivers are reminded an appointment is necessary before meeting with teachers as they have class, playground duty and other commitments during the school day.

## **WHAT'S HAPPENING WITH HARRY?**

Harry is growing and fast! He is now fifteen weeks old and has started his training as an assistance dog. Today was his first full day with students and included a reunion with his brother Fergus, an excursion with the support students to Tamaruke Kennels where he was born, and a staff meeting. Harry will be back for more visits over the coming weeks to help him become comfortable in the school environment, which will soon be like a second home to him. Stay tuned for more news about Harry's adventures at Rutherford Technology High School.

*Lyn Walkerden*

*HT Special Education*



# **EXECUTIVE REPORT**

## **UPGRADE**

At long last the upgrade to the school should be starting next week. While the work is carried out there has been the necessity to relocate several departments. The front office and sickbay are now in D25, the easiest way to access this area is through the bottom car park that is located near the Agriculture block. If you need to collect a sick child or attend a meeting with a teacher or Deputy Principal, this is your first port of call.

A reminder to all students that entering and exiting the school is not allowed through this car park for safety reasons. Instead, the gate at the back of the school and also the gates in front of the cola on Avery St are to be used.

## **YEAR 12**

By the time this newsletter is released, the HSC will have finished. The staff at RTHS would like to wish all of our Year 12 student's luck for the future. We look forward to reporting on their results and future paths. The Formal is to be held on Tuesday 11 November at the Crowne Plaza Pokolbin. The students and staff that are attending are looking forward to a great evening.

## **STRATEGIC PLANNING TEAM**

A Community team of parents, staff and students are working hard on planning for the next few years. The team meets fortnightly and progress is constantly being made on a variety of issues that concern RTHS students and the wider community. We thank them for their feedback and also for donating their time for this very important project.

## **YEAR 6 GALA DAY**

On the 28th October, students from our partner primary schools were invited to attend a Gala Day at Maitland Park. Students formed teams and were involved in many fun activities. A delicious BBQ lunch was provided for the students and a fantastic day was had by all.

## **PEER SUPPORT TRAINING**

Fifty five year Ten students have spent two days at Peer Support Training. Possessing these newly acquired skills will enable them to help with the Year 6 transition this week. Having this extra support available makes the sometimes overwhelming move from primary school to high school a lot easier.

## **PEER MEDIATION TRAINING**

Year 9 students will begin their journey to becoming Peer Mediators on the 18th of November. These students are trained to act as mediators with students in conflict.

## **SENIOR STUDENTS**

Teachers have completed Year 11 reports and have already started teaching Year 12 content. Students in Year 12 will receive their Assessment Task Booklets next week and it is a good idea for parents/carers to take a look too and familiarise themselves with the rules and regulations of the HSC. The HSC can be daunting for students and parents alike. Parents should spend some time with their children, learning about their subject choices and assessment task due dates. Start early...too early? NEVER!!!!

## **ATTENDANCE**

I remind all students about the protocols of leaving school during the day. If sick, students may report to Sick Bay with a note from their teacher, contact will be made with family and if possible, students will be collected by a family member. Students must not call home themselves. They will then be signed out of school by the office staff. Students must not simply leave the school. It will be treated as truancy by the school and the usual school protocols will be followed.

## NAPLAN 2014

As in previous years, our students have performed extremely well in the NAPLAN exams. The results have once again cemented Rutherford Technology High School as a great school.

Well done and congratulations to all of the students involved.

Your child's report will show his or her results in comparison with all other students from the same year group in Australia who sat the tests and will include:

- The national average
- The range for the middle 60 per cent of students
- Whether your child has achieved the national minimum standards

An important feature of the national assessments is that your child's achievement in literacy and numeracy is now measured against common national assessment scales that continue from Year 3 through to Year 9. This means that as your child advances through school and has these assessments every second year, you will be able to monitor your child's progress in literacy and numeracy.

Another important feature of the report is how the achievement of the national minimum standard is shown. The old 'benchmark' report showed achievement of the national minimum standard as being above or below a single score. The new report shows the national minimum standard as a full band on the scale. For example, the national minimum standard for Year 7 is Band 5. If your child's result is in this band, then he or she has typically demonstrated the basic elements of literacy and numeracy needed to participate in school in Year 7. If your child's result is in the bottom band for the year level, he or she has not achieved the basic skills of literacy and numeracy for that year and needs focused intervention and additional support to help achieve the skills required to fully participate in schooling.

If you would like further general information about the new national literacy and numeracy assessments, please visit [http://www.naplan.edu.au/home\\_page.html](http://www.naplan.edu.au/home_page.html) or contact Mrs Walkerden Head Teacher Support

**Simone Hughes**  
**Deputy Principal**

# Facebook Privacy Cheat Sheet

Who can see my stuff?

1. Click on this PADLOCK first

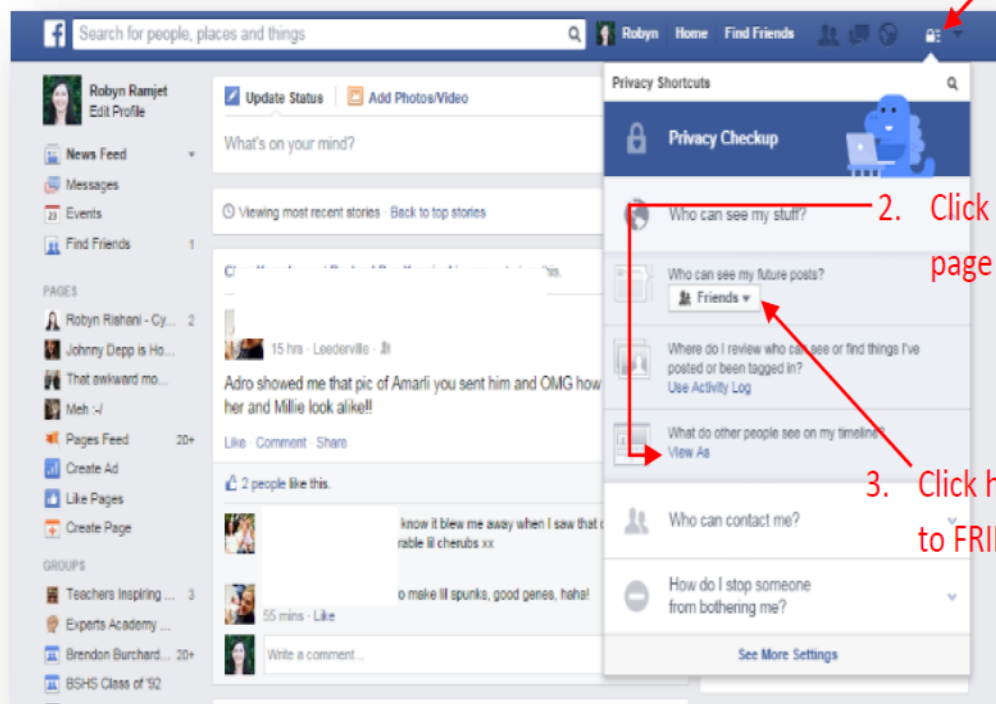

2. Click VIEW AS to see what your page looks like to strangers

3. Click here and change to FRIENDS

## CAPA NEWS

The CAPA staff would like to congratulate the Year 12 students of Drama, Music and Visual Arts for completing their main HSC Board of Studies projects.

The Drama class each had one group and one individual performance to present to markers over two days. Many thanks to Melissa Travis of year 10 who stepped in to assist with one of the group performances.

The Music class all decided on elective performances and so in week 9 they presented a total of 20 projects to markers. It would not have been so successful if not for the contribution of the Year 10 Music class who stepped into play in group pieces. Thanks to Caitlin Pettit, Jack Williams, Ryan Peters, Ryan Paton, Emily Lambourne, Grace Quilty, Lily Crockett, Eula Pacamalan, Lara Butler and Kate Butler for the time given in rehearsing with and performing with the students. A lead up to both of these HSC classes performances were the Annual Drama and Music nights for parents and invited guests.



**Photo: Students from the Year 12 Music class at their final rehearsal for their HSC performance exam. From left to right: Mason Brett – digital drum kit, Ryan Peters (yr. 10) - guitar, Ashlee Brown - vocals, Josef Pemberton - digital piano and Lane Southern – Bass guitar.**

The Visual Arts class has worked tirelessly to present a major body of work and an accompanying portfolio. There was great diversity in this year's artworks which included printmaking, video works and mixed media. The works were marked off site on October 23<sup>rd</sup> at Telarah Public School. Thanks to Mr Gadd for his assistance in providing us a space for the BOS markers. On November 18<sup>th</sup> the P&C committee will review all the year 12 artworks and will select one to buy for the school.



**Elisabeth Arnold**  
**"The problem with perfect"**



**Hannah Witherdin**  
**"Eraser"**



**Molly Crissell**  
**"I am interstitial"**

At the end of Term Three the Year 10 Drama class spent a day filming their group projects at Walka water works. They have since spent time with Mr Wirth and Mr O'Callaghan editing their films and we look forward to see their final product. Meanwhile, the year 9 drama class have also spent a day filming their group projects in various locations around the school. We also look forward to seeing the final products from these very keen and dedicated students.

**Ms Loretta Hornery**  
**Head Teacher CAPA**



## INDIGENOUS SHIRTS

Students who ordered an Indigenous Shirt during Term 3 should be aware that the shirts have been ordered through our supplier and after consultation with them they should be available very soon (hopefully during Week 5 of school). Students needing to collect them will need to see Mr Bower in the PE staffroom.



## SISTA SPEAK

Indigenous girls who participate in the Sista Speak program are working hard to update and complete the Indigenous mural. Sharnie Hampton, Robyn Draper, Aleisha Bailey, Hayley Conrades, Charli Gaiter and Deja Draper are part of the team painting the mural.

The girls organized a survey asking the Indigenous students where their families had originated. From that information the names and totems of those locations have been painted on the mural. The next step in the project is to connect, by using tracks, the totems to the Eagle representing the Wonnarua people's traditional lands which are located in the Hunter Valley area.



## DONATION OF BOOKS TO LIBRARY

The students and staff of RTHS would like to thank Linda Benton and David Rule for donating fifteen copies of their book "Two feet forward". The book tells the story of their travels around the world.

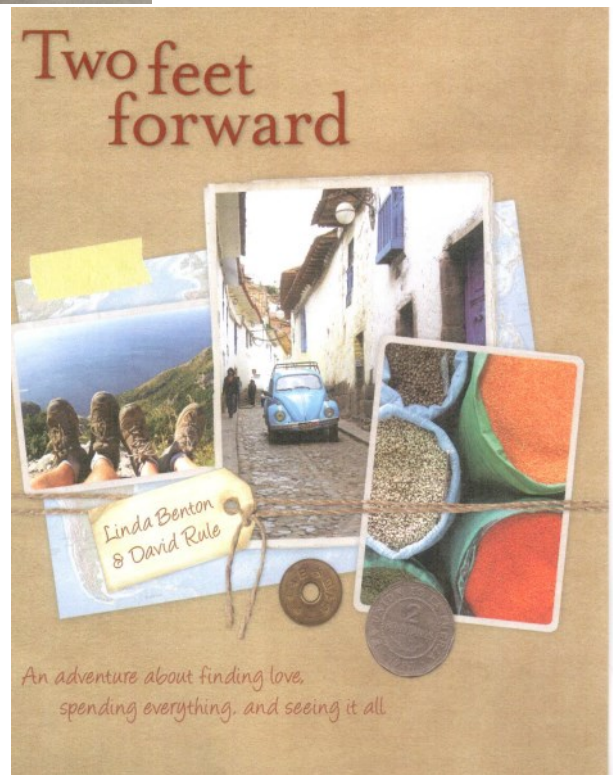

## YEAR 9 NEWS

During week 2, some Year 9 students took part in the attendance BBQ, rewarding students for having a high attendance. As you are aware it is only logical that high attendance rates go hand in hand with increased academic achievement. In saying this it is only fitting that these students' achievement is recognised. Also this term the girls participating in the Shine program have enjoyed creating craft boxes as an outlet for anger and anxiety management. This strategy is proven to encourage positive thought recognition through identifying things or aspects in their lives that make them feel good about themselves. These items are placed in the box they have created which then acts as a touchstone for these young ladies to revisit in times of personal hardship.

**A reminder for Year 9 students to return permission notes and payments for the Wet and Wild Excursion on 26th November as soon as possible.**



### **EXPRESSION OF INTEREST FOR ASSISTED TRAVEL SUPPORT OFFICER (ATSO) POSITION**

The Assisted School Travel Program (ASTP) often provides additional support to students with disabilities on transport. Assisted Travel Support Officers (ATSOs) support students with complex health or behaviour needs to ensure their safe travel to and from school. If you are interested in temporary part-time work as an ATSO the following website contains information on how to apply for the position.

[www.schools.nsw.edu.au/studentsupport/programs/astp/index.php](http://www.schools.nsw.edu.au/studentsupport/programs/astp/index.php)

For further information please contact ASTP on 1300 338 278 or email ASTP at [atso.astp@det.nsw.edu.au](mailto:atso.astp@det.nsw.edu.au)

### **YEAR 9 PANEL MEMBERS FOR IMPRESSIONS 10.**

Congratulations to the fifty one Year 9 students who have volunteered to be the student representative on the 'Impressions 10' - Mock Interviews panels. Already training sessions have taken place allowing the students to become familiar with the interview process. After attending the 'Impressions 10' in November, the students will be well equipped for their turn when they are in Year 10.

### **RUTHERFORD HIGH: RUTHERFORD ROTARY: RYPEN.**

Nine students from Years 9 & 10 applied for positions to the Rotary Youth Program of Enrichment (RYPEN) camp to be held at Myuna Bay during early November. Three students were successful in their applications. Congratulations to: Kaileb Owen, Meg Cook and Emma Russell.

The Rotary Club of Rutherford/Telarah has continued to provide services and sponsorship to our students. Thank you to the Club for their ongoing support of RTHS students.

The Rotary District 9670 selection panel had a very difficult time in choosing the students who would gain the most by experiencing this camp program. Normally only one student per school is offered a placement. Nine applications made the task very challenging for them.

***Marilyn Porter***

***RTHS Community Liason Officer***





## THANK YOU TO WOOLWORTHS, RUTHERFORD.

Three times a week, out of date bread is donated by Woolworths, Rutherford, to the school for the animals in the Ag plot. The Hereford heifer relishes the stale bread rolls being fed to her by Montana Evans. The chickens chase Hannah McDonagh-Bruce when they see the bread in her hands.

A great big thank you to Woolworths for supporting the school on a regular basis. The pasture at the Ag plot has suffered during this hot and dry weather and the bread is a valued and appreciated feed supplement.



## RUTHERFORD SHOW TEAM

For our last Show Team event for 2014 the students participated in The School Steer Challenge. Along with 30 other schools we were allocated a steer from Waverley Station in June. For the next four months the students trained and prepared the steer for show and then participated in the 2014 Beef Bonanza held in Scone from 24<sup>th</sup> - 27<sup>th</sup> October.

Emma Woodhouse Year 10, Meri Barbie Year 9, Jasmine Fohmsbee Year 9, Nathan McGrath Year 9 and Mrs Hull camped at Scone for the weekend which was difficult in the heat, but we had lots of fun, we had a water fight to cool down. Our steer's name was Midge and he was approximately 18 months old and he did very well. He came 3<sup>rd</sup> in the Light Weight class led by Jasmine and 5<sup>th</sup> in the Champion Light Weight class led by Meri. We all worked very hard and Midge was very well behaved. We all had a very early and bad wake up call to find our steer missing on Sunday morning, luckily we found him in time to get him ready for parading. We all wanted Emma to have his old ear tag as she worked with him the most. We all will miss him but we won't miss his stubbornness. Thank you to Mrs Hull for taking us and looking after us at the show.

**Emma, Meri, Jasmine and Nathan**  
**RTHS Show Team**



# RUTHERFORD TECHNOLOGY HIGH SCHOOL

*Preparing for the Future*

Email:  
[admin@rutherfordhs.nsw.edu.au](mailto:admin@rutherfordhs.nsw.edu.au)  
[www.rutherfordhs.nsw.edu.au](http://www.rutherfordhs.nsw.edu.au)

Avery Street  
RUTHERFORD  
2320

Telephone:  
02.4932.5999

Fax: 02.4932.8166

Dear Parent or Carer

The Essential Secondary Science Assessment (ESSA) test for Year 8 students will be held between **Monday 10 November** and **Friday 14 November 2014**. The test takes approximately 80 minutes. The test is an interactive, multimedia test completed entirely on a computer. It is called ESSAonline.

ESSAonline contains multiple choice, short response and extended response tasks that are grouped around real-world issues, including scientific investigations. This is a diagnostic test, with tasks framed on Stage 4 outcomes and essential content in the *NSW Science Years 7–10 Syllabus*. Students will be tested on their:

- knowledge and understanding of science
- understanding and skills in the process of scientific investigation
- ability to evaluate evidence, make judgements and think critically
- ability to access information and communicate scientific ideas.

Students also complete a survey about their opinions, attitudes and values.

Since students complete ESSAonline on a computer, each student needs to bring **headphones or earbuds** that plug into a school computer. Earbuds for an ipod or portable player are suitable.

If your child has a disability that needs special consideration or has been educated in English for less than one year, please contact your child's school to discuss special provisions or possible exemption from the test.

Results of the test will be available during Term 1 2015. Information about each student is treated confidentially and held securely to ensure that the right to privacy of all students is maintained. A personal report for each student will be sent to parents/carers to describe the science knowledge and skills demonstrated by the student in the test. There will also be information about how your child's results compare with overall performance of all students in the test. You will be invited to complete a parent survey about the test and science learning.

The principal of your child's school is able to provide you with more details about the ESSA program if you require additional information.

Yours sincerely

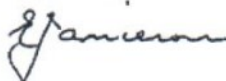

Eric Jamieson  
**Director, High Performance**  
Department of Education and Communities





Available on the  
**App Store**

## Rutherford Technology High School now has a Phone App!

Great News! Our school now has a mobile phone and iPad app. What's that you may ask, it is a little application that sits on your phone and gives you instant access to our school information when you click on it, 24/7. The app is going to give parents the ability to instantly access newsletters without going to the website, or to send in a sick note while you stand outside the school because you forgot to write a paper note! We will be sharing many of the other features with you over the coming weeks, but for now download it to your Smartphone or iPad by going to either the Apple App Store or Android Google Play Market and search for Rutherford Technology High. Once you have found it press install or download.

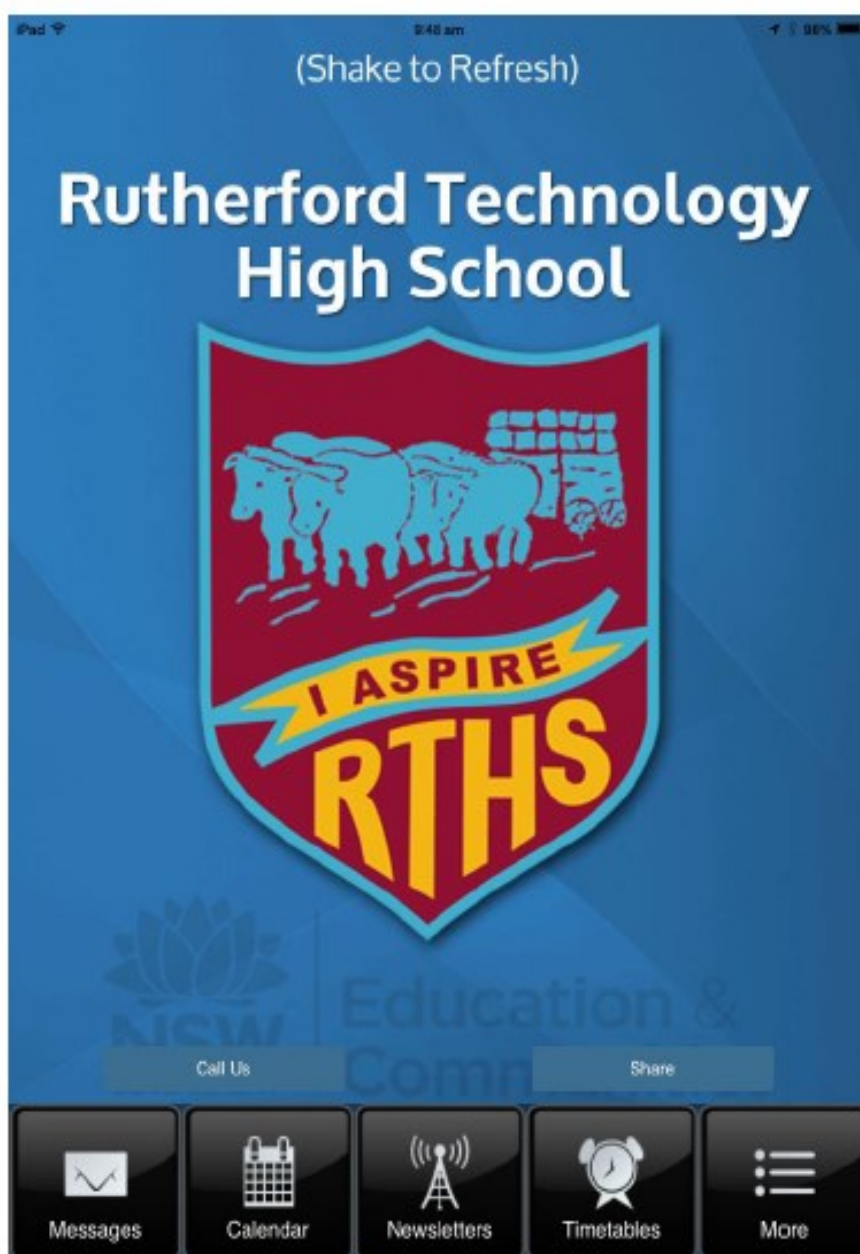

# RUTHERFORD TECHNOLOGY HIGH SCHOOL

## CANTEEN MENU

2014



ROLLS AND WRAPS	PRICE	HOT FOOD	PRICE
Salad Roll	\$4.00	Chicken Wedge/Dino/Pop Corn	\$2.80
Chicken Salad Roll	\$4.50	Pizza Single Ham & Pineapple	\$2.20
Ham Salad Roll	\$4.50	Hot Dog	\$2.20
Corn Meat Salad Roll	\$4.50	Pizza Slab	\$2.50
Chicken Salad Sandwich	\$3.80	Pizza Rounds	\$2.20
Salad Sandwich	\$3.40	Chicken Burger	\$3.50
Egg & Lettuce	\$2.60	Chicken Burger Salad	\$4.20
Curried Egg	\$2.60		
Vegemite	\$1.60	Plain Pies	\$2.60
Cheese	\$2.40	Sausage Rolls	\$2.50
Ham, Cheese & Tomato	\$2.90	Cheese & Bacon/Potato Pies	\$2.90
Cheese & Tomato	\$2.60	Mamee Cup Noodles (chicken)	\$2.00
Corn Meat & Pickles	\$2.90	Chicken Gravy Rolls	\$3.50
Chicken Salad Wrap	\$4.50	Rissole Gravy Rolls	\$3.50
Thai Chicken Salad Wrap	\$4.50	Roast Beef Gravy Rolls	\$3.50
Salad Wrap	\$4.00	Cheese Burger	\$3.50
Meat Salad Wrap	\$4.50	Cheese Burger Salad	\$4.20
Salad Boxes	\$4.80	Chicken Chippies (6)	\$2.80
Chicken Salad Boxes	\$5.80	Chicken Nuggets (6)	\$2.80
		Garlic Bread	\$2.00
<b>EXTRAS</b>			
Bread Roll (Extra)	\$0.90	<b>SNACKS</b>	
Butter Bread	\$0.80	Fresh Fruit Salad Term 1&4	\$2.50
Toasted Sandwiches (order only)	\$0.50	Fresh Water Melon Term 1&4	\$2.50
Extra Items	\$0.20	Deli Rock Chips	\$1.00
Tomato/BBQ Sauce	\$0.40	JJ's Chips	\$1.00
		Cheese Rice Sticks	\$1.00
<b>DRINKS</b>		Chicken Jumpy's	\$1.00
Moove Milk 500ml	\$3.00	Eucalyptus Drops	\$0.50
Moove Milk 300ml	\$2.00	Muffins	\$1.40
Juice 300ml/375ml	\$2.00	Finger Buns	\$1.40
Water 600ml	\$2.00	Banana Bread	\$2.40
Soft Drink 600ml	\$3.00		
Soft Drink 390ml	\$2.50	<b>ICE-CREAMS</b>	
FOCUS Water	\$1.50	Billabongs	\$1.50
AROONA Water	\$1.30	Paddle Pops	\$1.50
Plain Milk 600ml	\$2.00	Frosty Fruits	\$2.00
Small Water	\$1.00	Frozen Yoghurts	\$1.70
Hot Chocolate Term 2/3	\$1.50	Vanilla Buckets	\$1.00
Quench	\$1.50	Paddle Pop Thick Shake	\$2.20
		Paddle Pop Lemonade Twist	\$1.10
		Calippo Mini	\$1.10
		Juices	\$0.90
		Fruit Super Doopers	\$0.70
		Milo Cups	\$2.60



[illegible]





Talk to the home loan experts

Your local Mortgage Choice broker Karen Jones, can help you with:

- Home loans & refinancing
- Property investment & insurance
- Car loans & equipment finance

☎ 0408 259 648 ✉ karen.jones@mortgagechoice.com.au

Mortgage Choice Limited ACN 009 161 979. Australian Credit Licence 382869.

## Mobile Makeup & Beauty

### Formal Makeup

Includes false eyelashes

**\$40.00**

Add nails & a mini facial for

**\$30.00**

Mineral based makeup safe for sensitive skin non  
congesting for oily skin.

Kerrie 0434432898



Genesis Rutherford has membership  
starting from **\$ 13.95** student memberships  
available to all students above 12 years of  
age.

Whether you're looking for:

**Lean muscle**

**Weight loss**

**Strength and tone**

**Bulking up**

**Or just after that summer body**

We can help you get your fitness journey  
underway

And refer any friend before the end of  
October and they join you will receive 2  
weeks FREE on your membership!!

So get in quick to take advantage of this  
great offer

And you will receive a bonus:

**Free consultation with a personal trainer**

**Free personal training session**

**RUTHERFORD  
MECHANICAL REPAIRS**

ENGINE/EXHAUST  
ANALYSER

**4932 5982**  
Proprietor: David

Fleet Card

**27 John Street, RUTHERFORD 2320**

EFFI-LPG

#### CANTEEN

#### ROSTER



3 November  
4 November  
5 November  
6 November  
7 November  
10 November  
11 November  
12 November  
13 November

K Cresswell  
Volunteer required  
Volunteer required  
D Potts  
Volunteer required  
K Cresswell  
Volunteer required  
Volunteer required  
D Potts

Rutherford Technology High School has launched its  
Official Facebook Page – just go to Facebook and  
look for “Rutherford Technology High School NSW  
Official Site” and click on “Like”.

We will be using the Facebook page to keep everyone  
informed about events at the school, important dates  
for your diary, and general information about the  
school.

Link: [http://www.facebook.com/  
RutherfordTechnologyHighSchool](http://www.facebook.com/RutherfordTechnologyHighSchool)



0401 199 913

11 Bradmill Avenue, Rutherford



This card entitles the bearer to one  
**COMPLIMENTARY SESSION**